

VF VEDAÇÃO E FIXAÇÃO LTDA.

ANEL RASPADOR TIPO D EM POLEGADAS

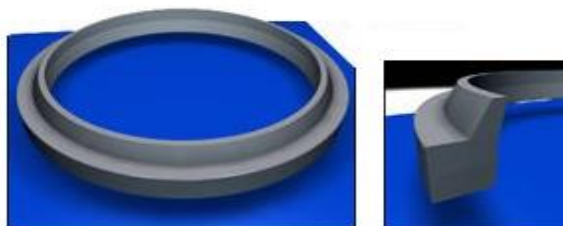

Código	Haste	Externo	Base
D-0250	1/4"	1/2"	1/8"
D-0312	5/16"	9/16"	1/8"
D-0375	3/8"	5/8"	1/8"
D-0437	7/16"	8/16"	1/8"
D-0500	1/2"	3/4"	1/8"
D-0562	9/16"	13/16"	1/8"
959-03	5/8"	7/8"	3/32"
D-0625	5/8"	7/8"	1/8"
D-0687	11/16"	15/16"	1/8"
940/959-5	3/4"	1"	3/32"
D-0750	3/4"	1,1/8"	3/16"
D-0812	13/16"	1,3/16"	3/16"
D-0875	7/8"	1,1/4"	3/16"
D-0937	15/16"	1,5/16"	3/16"
959/940-9	1"	1,1/4"	3/32"
D-1000	1"	1,3/8"	3/16"
959/10	1,1/16"	1,5/16"	3/32"
D-1062	1,1/16"	1,7/16"	3/16"
D-1125	1,1/8"	1,1/2"	3/16"
D-1187	1,3/16"	1,9/16"	3/16"
D-1250	1,1/4"	1,5/8"	3/16"
940/959-15	1,3/8"	1,5/8"	3/32"
D-1312	1,5/16"	1,11/16"	3/16"
D-1375	1,3/8"	1,3/4"	3/16"
D-1437	1,7/16"	1,13/16"	3/16"
959/940-17	1,1/2"	1,13/16"	3/32"
D-1500	1,1/2"	1,7/8"	3/16"
D-1562	1,9/16"	1,15/16"	3/16"
959/940-18	1,5/8"	1,15/16"	3/32"
D-1625	1,5/8"	2"	3/16"
D-1687	1,11/16"	2,1/16"	3/16"
959/19	1,3/4"	2"	3/32"

Código	Haste	Externo	Base
D-1750	1,3/4"	2,1/8"	3/16"
D-1812	1,13/16"	2,3/16"	3/16"
D-1875	1,7/8"	2,1/4"	3/16"
D-1937	1,15/16"	2,5/16"	3/16"
959/21	2"	2,1/4"	3/32"
D-2000	2"	2,1/2"	1/4"
D-2062	2,1/16"	2,9/16"	1/4"
D-2125	2,1/8"	2,5/8"	1/4"
D-2187	2,3/16"	2,11/16"	1/4"
D-2250	2,1/4"	2,3/4"	1/4"
D-2312	2,5/16"	2,13/16"	1/4"
D-2375	2,3/8"	2,7/8"	1/4"
959/25	2,1/2"	2,3/4"	3/32"
D-2437	2,7/16"	2,15/16"	1/4"
D-2500	2,1/2"	3"	1/4"
D-2562	2,9/16"	3,1/16"	1/4"
D-2625	2,5/8"	3,1/8"	1/4"
940/959-2	2,3/4"	3,3/32"	7/64"
D-2687	2,11/16"	3,3/16"	1/4"
D-2750	2,3/4"	3,1/4"	1/4"
D-2812	2,13/16"	3,5/16"	1/4"
D-2875	2,7/8"	3,3/8"	1/4"
D-2937	2,15/16"	3,7/16"	1/4"
D-3000	3:"	3,1/2"	1/4"
D-3125	3,1/8"	3,5/8"	1/4"
D-3250	3,1/4"	3,3/4"	1/4"
D-3375	3,3/8"	3,7/8"	1/4"
D-3500	3,1/2"	4"	1/4"
D-3625	3,5/8"	4,1/8"	1/4"
D-3750	3,3/4"	4,1/4"	1/4"
D-3875	3,7/8"	4,3/8"	1/4"
D-4000	4"	4,1/2"	1/4"

ANEL RASPADOR TIPO D EM POLEGADAS

Código	Haste	Externo	Base
D-4125	4,1/8"	4,5/8"	1/4"
D-4250	4,1/4"	4,3/4"	1/4"
D-4375	4,3/8"	4,7/8"	1/4"
D-4500	4,1/2"	5,1/4"	3/8"
D-4625	4,5/8"	5,3/8"	3/8"
D-4750	4,3/4"	5,1/2"	3/8"
D-4875	4,7/8"	5,5/8"	3/8"
D-5000	5"	5,3/4"	3/8"
D-5125	5,1/8"	5,7/8"	3/8"
D-5250	5,1/4"	6"	3/8"
D-5375	5,3/8"	6,1/8"	3/8"
D-5500	5,1/2"	6,1/4"	3/8"
D-5625	5,5/8"	6,3/8"	3/8"
D-5750	5,3/4"	6,1/2"	3/8"
D-5875	5,7/8"	6,5/8"	3/8"
D-6000	6"	6,3/4"	3/8"
D-6250	6,1/4"	7"	3/8"
D-6500	6,1/2"	7,1/4"	3/8"
D-6750	6,3/4"	7,1/2"	3/8"
D-7000	7"	7,3/4"	3/8"
D-7250	7,1/4"	8"	3/8"
D-7500	7,1/2"	8,1/4"	3/8"
D-7750	7,3/4"	8,1/2"	3/8"
D-8000	8"	8,3/4"	3/8"
D-8125	8,1/8"	8,7/8"	3/8"
D-8250	8,1/4"	9"	3/8"
D-8500	8,1/2"	9,1/4"	3/8"
D-8750	8,3/4"	9,1/2"	3/8"
D-9000	9"	9,3/4"	3/8"
D-9250	9,1/4"	10"	3/8"
D-9500	9,1/2"	10,1/4"	3/8"
D-9750	9,3/4"	10,1/2"	3/8"
D-10000	10"	11"	3/8"
D-10250	10,1/4"	11,1/4"	1/2"
D-10500	10,1/2"	11,1/2"	1/2"
D-10750	10,3/4"	11,3/4"	1/2"
D-11000	11"	12"	1/2"
D-11500	11,1/2"	12,1/2"	1/2"